



# AUTO REFKERATO ARKM-200

Aiming at new levels in quality



# AUTO REFKERATO ARKM-200

## New Generation of Multi-Functional Instrument



Highly accurate measurement combined with short examination time and ease of use makes working with the ARKM-200 both professional and quick. The advanced touch-screen display allows you to perform both refraction and keratometry automatically with one simple movement. Capture one eye on the display and the ARKM-200 will do both eyes automatically. With the new features, the ARKM-200 will surely make your office more efficient

- Various settings like changing modes can be done on the touch panel display.
- The wide viewed fixation target assures natural fixation to avoid accommodation of a patient's eye.
- The quick thermal printer has shortened the total measurement time.

### 1 Automatic Measurement

1. Use power assist joystick for rough alignment.
2. Touch the center of the pupil on the display with your fingertip and ARKM-200 will automatically align and begin measurement.
3. Press the R/L Icon on the display and the instrument will automatically move to and measure the other eye.
4. Printing is automatic.

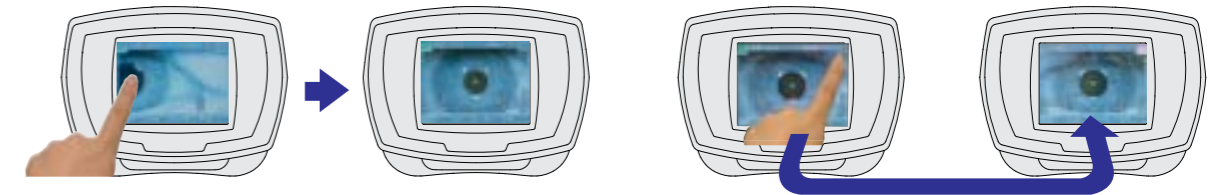

### 2 Power Joystick

- Move the joystick ring up/down and the instrument head moves up/down quickly.
- Move the joystick hand rest to the right/left or backward/forward and the instrument head moves to the right/left or backward/forward quickly.
- Rotate the joystick ring and the instrument head moves up/down slowly.
- Tilt the joystick and the instrument head moves in each direction slowly.



### 3 Power Chinrest

- The chin rest can be moved by pushing the buttons on the front panel. No need to reach out to the chin rest for manual adjustment.



### 4 Refractometry

- Normal Mode:**  
Fogging is applied automatically for each measurement for more accurate results.
- Quick Mode:**  
Fogging is applied as needed for consecutive measurements.
- IOL/CAT Mode:**  
The mode is used to measure cataract or pseudophakic eyes.



### 5 Keratometry

- Short consecutive measurements and provide reliable data.
- Measurements at  $\Phi 6.0\text{mm}$  ( $R=8.0\text{mm}$ ) as well as at  $\Phi 3.0\text{mm}$  give you enough information for contact lens fitting.
- Base curves of contact lenses are stored, categorized and suggested manufactures are automatically printed.



### 6 Diameter Measurement of Cornea and Pupil

- Measurement can be done easily by moving the two cursors on the display to the boundary of Cornea or Pupil. This is useful for deciding the diameter of a contact lens and for other contact lens fitting practices.





## Specifications

Measurement Ranges		
<b>Refractometry</b>	Sphere	-25.00 to +22.00D ( VD=12.00mm)
	Cylinder	-10.00 to +10.00D ( VD=12.00mm)
	Axis	0 to 180 degrees
	Minimum Pupil Dia.	φ 3.00mm / φ 6.00mm
	Measurement Time	0.2 sec.
<b>Keratometry</b>	Range	5.00mm to 11.00mm
	Corneal Refraction	30.68D to 67.50D ( n=1.3375)
	Corneal Astigmatism	0 to 10D ( n=1.3375)
	Axis	0 to 180 degrees
	Measured Area	φ 3.00mm / φ 6.00mm ( at 8.0mm of Corneal Radius)
	Measurement Time	0.1 sec.
<b>PD measurement</b>		50mm to 86mm
<b>Diameter Measurement of Cornea and Pupil</b>		1.0mm to 14mm
<b>Chinrest</b>		Power Chinrest
<b>Printer</b>		High Speed Thermal Line Printer
<b>Output port</b>		RS-232C
<b>Power Requirement</b>		AC-100 to 240V 50/60Hz 130VA
<b>Size</b>		466mmH x 300mmW x 493mmD
<b>Weight</b>		19kgs

● Design and specifications are subject to change as improvements are made to the product.

**TAKAGI SEIKO CO.,LTD.**

330-2 IWAFUNE, NAKANO-SHI, NAGANO-KEN, 383-8585, JAPAN  
 TEL.+81-269-22-4512 FAX.+81-269-26-6321  
 URL:<http://www.takagi-j.com> E-mail:[info@takagi-j.com](mailto:info@takagi-j.com)

**CE**  
0123