

Lensmeter

# LM-10DX



Aiming at new levels in quality



## Lensmeter

# LM-10DX



### “Find a point of eco-environment for our future”

- 1 The light source changed from a conventional electric bulb type to an LED type which decreases CO<sub>2</sub> emission and also reduces the electric power consumption.
- 2 The cross-line pinhole type target enables accurate measurement.
- 3 Internal power reading
- 4 The analog type can measure a subtle difference in lens power that is not possible with a digital type.

## Specifications

Vertex Power	Range : +25 to -25D Step 0.125D up to ±3D / 0.25D beyond ±3D
Prismatic power	Range 5 Δ (in a visual field)/20 Δ (with a compensator) Step 1 Δ
Cylindrical axis	Range : 0° to 180° Step 1°
Measurable lens diameter	Range : φ 20mm to φ 80mm Cross-line pinhole type
Eyepiece focusing	+6D to -6D
Tilting angle	30° to 90°
Power source	AC100V, 120V, 230V
Power consumption	1.0VA
Dimension	380(H)×403(D)×180(W)mm
Weight	4.9kg

\* If you want to order the unit without prism compensator, please contact our sales department.

## Dimensions

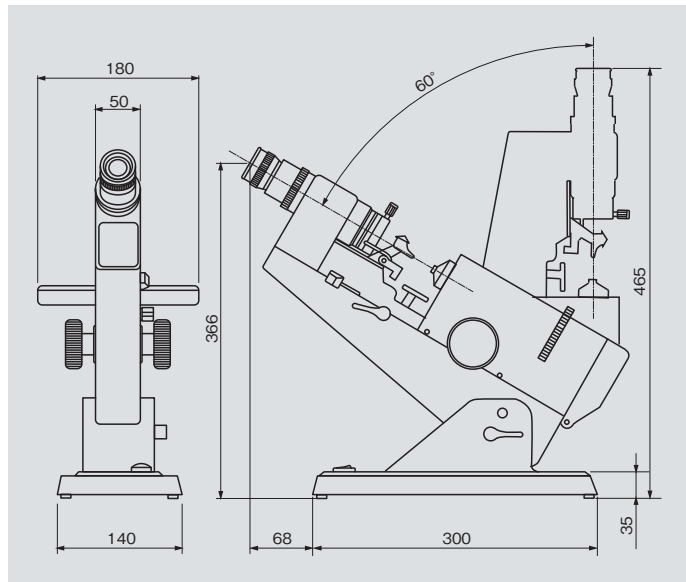

● Design and specifications are subject to change as improvements are made to the product.

**TAKAGI SEIKO CO.,LTD.**

330-2 IWAFUNE, NAKANO-SHI, NAGANO-KEN, 383-8585, JAPAN  
TEL.+81-269-22-4512 FAX.+81-269-26-6321  
URL:<http://www.takagi-j.com> E-mail:[info@takagi-j.com](mailto:info@takagi-j.com)

